

Vehicle Installation to suit trailers installed with the DC2DC Ignition Link Installed.

Smart Alternator Setup for DC2DC no IGN



Warning!!

Positive & Negative Input cables to the DC2DC Charger must run from the Start Battery Terminals (Not Aux Battery) If Vehicle fitted with Low Voltage Alternator, the Negative cable must be attached to the "System" side of the vehicle's computer sense module attached to the battery.

The High Amp Relay must be Ignition Switched (not a VSR) Failure to do this will result in poor charging or a flat start battery.

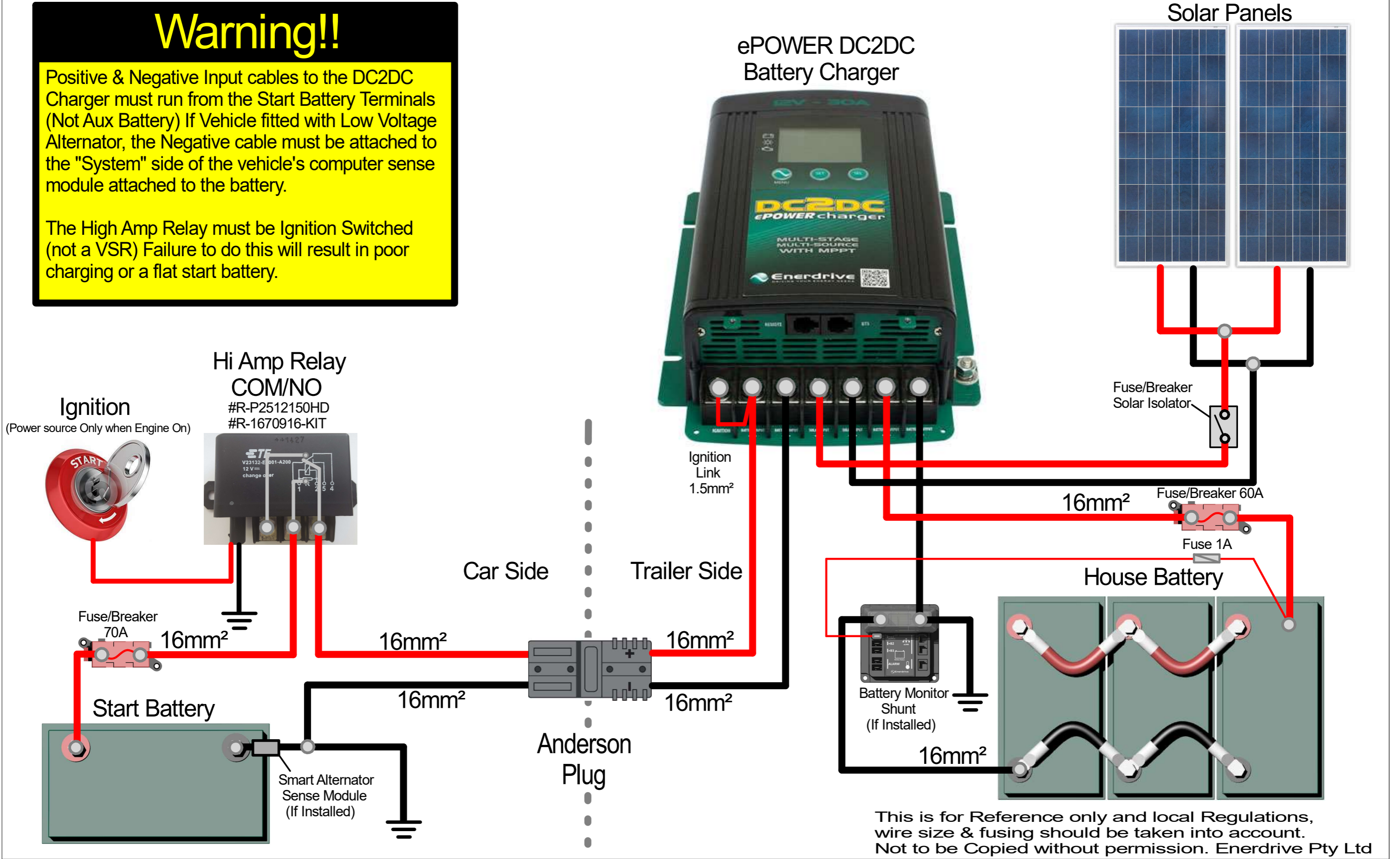

This is for Reference only and local Regulations, wire size & fusing should be taken into account. Not to be Copied without permission. Enerdrive Pty Ltd