

EPRO *PLUS* **alarm expander**



Installation Guide

QuickLink 2ch Alarm Output Expander Kit (#5093120)



Enerdrive

DRIVING YOUR ENERGY NEEDS

ePRO PLUS

alarm expander

1. Package Contents

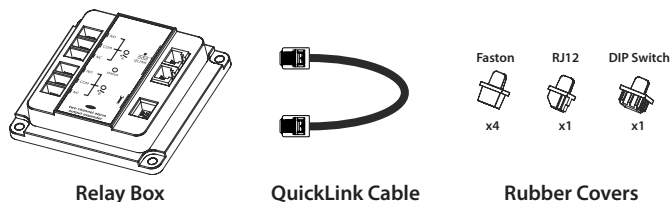

Relay Box

QuickLink Cable

Rubber Covers

2. Mounting The Relay Box

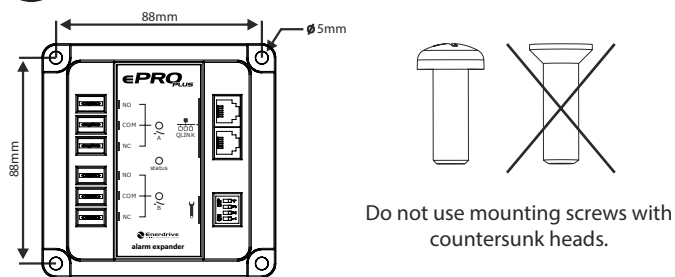

3. Connecting the Relay Box

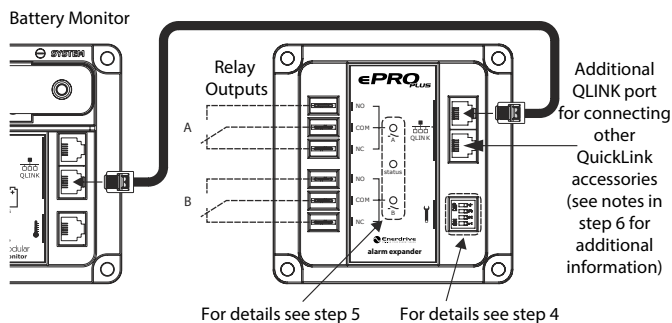

4. DIP Switch Settings

DIP Switch 1 (Operating Mode)



Normal operating mode. The alarm expander relays A and B are operating independently and can be controlled from the Quicklink master (i.e. battery monitor) by linking an alarm condition to EXT. 1, EXT.2 etc., depending on alarm expander address (see table 1 in next column).



Contactor mode (latching). The alarm expander relays A and B are combined in order to control the 'open (reset)' and 'close (set)' coils from a dual coil magnetically latching contactor. Which relay contact to use for controlling the contactor coils, depends on whether the contactor needs to operate in a Normally Open (NO) or Normally Closed (NC) configuration. For example, when an alarm requires a load to be disconnected from a battery, the contactor needs to operate in an NC configuration. However, when an alarm requires a source to be connected to a battery, the contactor needs to operate in a NO configuration. Table 3 shows the relay command types depending on the desired contactor configuration. When an alarm is activated, relay A will be operated. When an alarm is deactivated, relay B will be operated. In contactor mode, the alarm expander can only control one external contactor. See table 2 for more details.

DIP Switches 2, 3 and 4 (relay addressing)

DIP Switch	Relay		DIP Switch	Relay		Relay		
on	A	B	on	A+B	Contactor configuration		A	B
2 3 4			2 3 4		NO	Set	Reset	Set
off off off	EXT. 1	EXT. 2	off off off	EXT. 1	NO	Set	Reset	Set
off off on	EXT. 2	EXT. 3	off off on	EXT. 2	NC	Reset	Set	
off on off	EXT. 3	EXT. 4	off on off	EXT. 3				
off on on	EXT. 4	EXT. 5	off on on	EXT. 4				
on off off	EXT. 5	EXT. 6	on off off	EXT. 5				
on off on	EXT. 6	EXT. 7	on off on	EXT. 6				
on on off	EXT. 7	EXT. 8	on on off	EXT. 7				
on on on	EXT. 8	EXT. 9	on on on	EXT. 8				

Table 1 (normal operating mode)

Table 2 (contactor mode)

Table 3 (contactor configuration)

Set = Close contactor
Reset = Open contactor
Set = Sluit contactor
Reset = Open contactor

Set and Reset pulse times are approx. 750ms

5. LED Indications

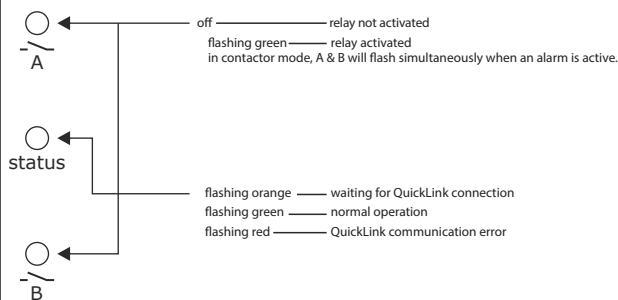

6. Specifications plus notes

Technical Specifications 2ch alarm output expander kit	
Communication bus type	QuickLink
Current consumption	< 1mA
Relay A and B contact ratings	8A / 250Vac or 8A / 30Vdc
Relay A and B dielectric strength	4000Vac (1 min) between coil and contacts
Relay pulse time (contactor mode)	Approx. 750 ms.
Operating ambiert temp.	-20 ... +50 °C
Dimensions (L x W x H)	100 x 100 x 24mm

*Notes

Each QuickLink network may contain only one master device (i.e. battery monitor).
Each QuickLink network may contain a maximum of four alarm expanders.

